



© Design: Paragon Kitchens, Ontario

C-CHANNEL

MIRALIS

THE ART OF THE KITCHEN



**THOSE WHO
APPRECIATE
CLEAN LINES WILL
DEFINITELY FALL
IN LOVE WITH
THIS DESIGN**

These handle-free cabinets open by simply placing your fingers in the hidden aluminum 'C' edges of the doors and drawers.

For an ultra-contemporary, intuitive design, opt for C-Channel.



3511 SA107-G Simply White





5064 Hickory
3511 SF116-M White Lace





© Design: Paragon Kitchens, Ontario



3511 SF119-M Black satin
3511 SW114-G Sonoma Oak





3511 SF116-M White Lace



3511 SF119-M Black satin
1501 H208 Blond Seaside

© Design: Paragon Kitchens, Ontario

IMPORTANT

Start with the C-Channel kitchen and everything else will follow. Cabinets and hardware are specific to this model and only slab doors can be used. The following is a guide to help you select and create a handleless C-Channel kitchen.
<https://youtu.be/47u10EBf0Gc>

Note: C-Channel aluminum bars must be attached to the cabinets, though not with wall cabinets. Your installer will have to cut the aluminum bar and then attach it to the cabinet.

TABLE OF CONTENTS

BASE

BF-CC	Base full height door	12
BS_F-CC	Base sink full height door	12
B1D-CC	Base 1 drawer	13
B2D-CC	Base 2 drawers	13
B3D-CC	Base 3 drawers	13
BC-CC	Base corner	14
BBC-CC	Base back corner	14
BBC_F-CC	Base blind corner full height door	14
BBFL-CC	Base box filler, Type L	15
BBFC-CC	Base box filler, Type C	15
	Important: base cabinets	13
	Important: side finishes	15
	Specifications: base cabinets	16

WALL

W-CC	Wall	17
WSS-CC	Wall stack section	17
WOSDT-CC	Wall open, door on top	18
WOS	Wall open shelves	18
WC-CC	Wall corner	18
WBC-CC	Wall blind corner	19
WBFU	Wall box filler, Type U	19
WBFL	Wall box filler, Type L	19
W-FR	Wall fridge	20
FP22-FR	Fridge panel	20
	Important: wall cabinets	17
	Specifications: refrigerator	21

TALL AND OVEN

TDODTDB-CCV	Tall double oven, door on top, drawer on bottom	22
TOMDTDB-CCV	Tall oven microwave, door on top, drawer on bottom	22
TU-CCV	Tall utility	24
TUH-CCV	Tall utility, Type H	24
TUG-CCV	Tall utility, Type G	24
TUF-CCV	Tall utility, full-height	25
TUOSMDTB-CCV	Tall middle open shelves, top and bottom doors	25
	Important: tall and oven	23

SPECIFICATIONS

Horizontal C-Channel Specifications	26
Vertical C-Channel Specifications	26
Upper Unit C-Channel Specifications	26

NOTE

All prices listed in this brochure are in addition to the basic unit price.

BASE DOORS

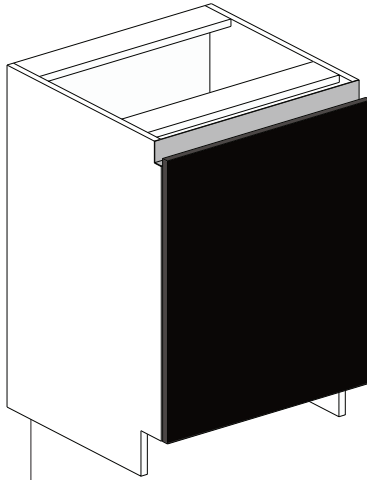

BF-CC
BASE
FULL HEIGHT DOOR
C-CHANNEL

- Available with 1 or 2 doors.

+ \$290/cabinet

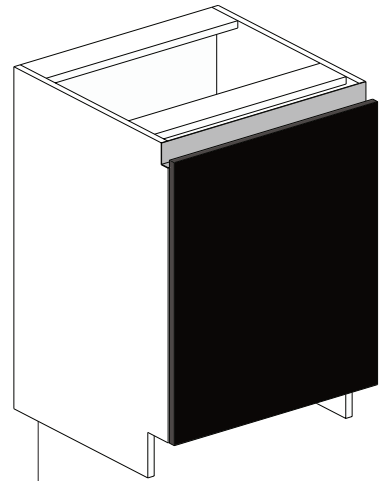

BS_F-CC
BASE SINK
FULL HEIGHT DOOR
C-CHANNEL

- The front rail can be removed to allow space for a large sink.

+ \$290/cabinet

NOTE

To help you prepare your order and reduce errors, **please send us a complete floor plan with every C-Channel order.**

Miralis will go over the design and determine the hardware required.

The price of hardware is already included in the price of each cabinet.

BASE DRAWERS

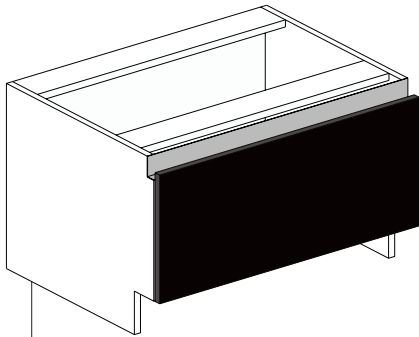

B1D-CC

BASE
1 DRAWER
C-CHANNEL

- Increase storage space by adding a roll-out shelf above the drawer.

+ \$290/cabinet

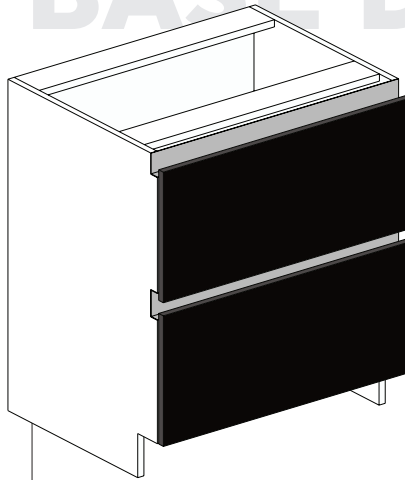

B2D-CC

BASE
2 DRAWER
C-CHANNEL

- The two drawer fronts are the same height.
- Increase storage space by adding a roll-out shelf above each drawer.

+ \$290/cabinet

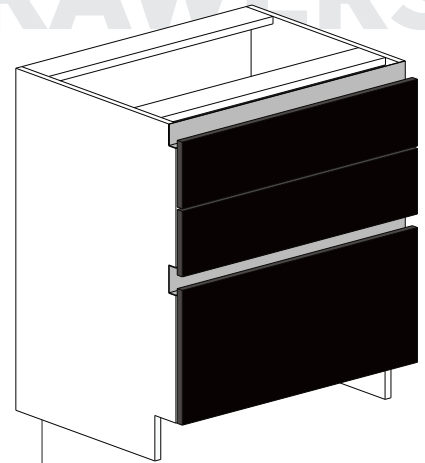

B3D-CC

BASE
3 DRAWER
C-CHANNEL

- The two upper-drawer fronts are the same height.
- The two upper-drawer fronts are the same height as the bottom-drawer front.
- Increase storage space by adding a roll-out shelf above the lower drawer.

+ \$290/cabinet

IMPORTANT

- The C-Channel is **placed in the upper or the middle of the unit.**
- There is **always** a C-Channel at the top of a base cabinet.
- Access space between fronts is **1 3/8"**.
- **Concealed dishwasher*?**
It must be set back 2 1/4" under the counter.

* One of the recommended models is the Miele G 4970 SCVi Futura Classic Series.

BASE CORNERS

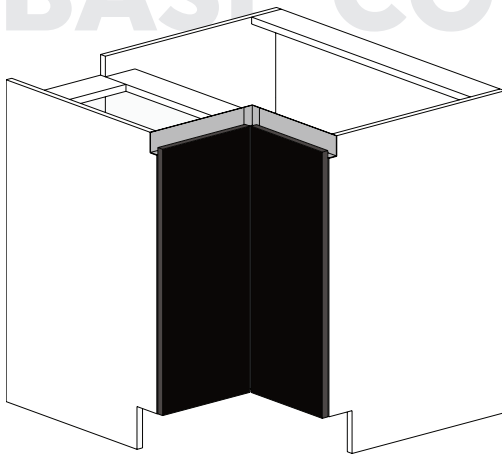

BC-CC

BASE CORNER C-CHANNEL

+ \$290/cabinet

- A Lazy Susan can be added for easy access to the cabinet interior.
- This cabinet is shipped in two sections.

BBC-CC

BASE BACK CORNER C-CHANNEL

+ \$290/cabinet

- A Lazy Susan can be added for easy access to the cabinet interior.

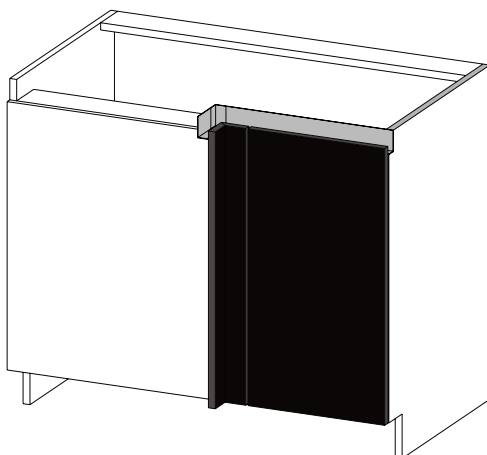
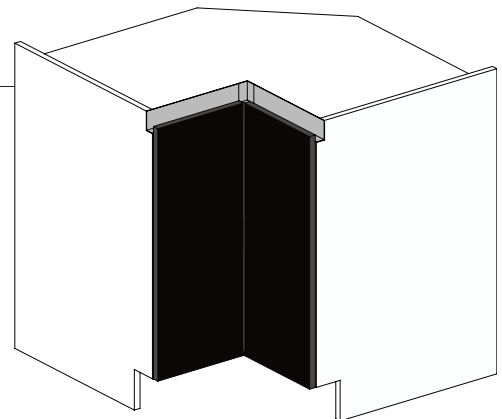

BBC_F-CC

BASE BLIND CORNER C-CHANNEL

+ \$290/cabinet
+ \$200/filler

- The default width of the blind corner panel is equal to the depth of the cabinet.
- For a perfect finish, a 3"x 3" corner filler is installed between the door and the blind corner panel.
- The blind corner comes unfinished.

- Unlike certain door models, the filler does not come with an aluminum T-Edge.

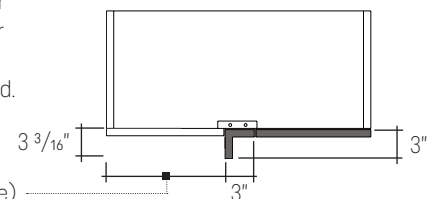

Width of the blind corner (variable)

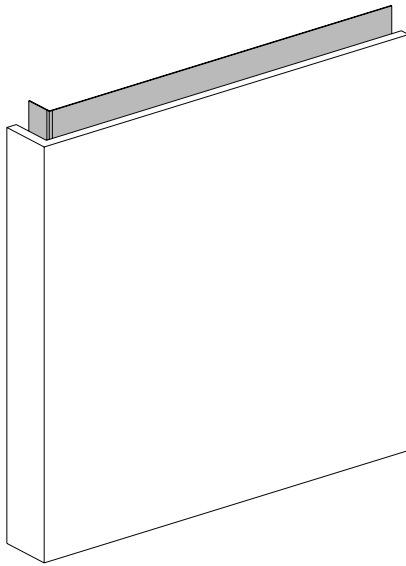

BBFL-CC

BASE BOX FILLER TYPE L C-CHANNEL

+ \$290/cabinet

- Designed for the C-Channel to continue around the cabinet side.
- All box fillers are 3" thick.
- The box filler is made of the same material as the doors.
- Unlike certain door models, it does not come with an aluminum T-Edge.

BOX FILLERS

BBFC-CC

BASE BOX FILLER TYPE C C-CHANNEL

+ \$290/cabinet

- Designed for the C-Channel to continue around the cabinet side and back.
- All box fillers are 3" thick.
- The box filler is made of the same material as the doors you order.
- Unlike certain door models, it does not come with an aluminum T-Edge.

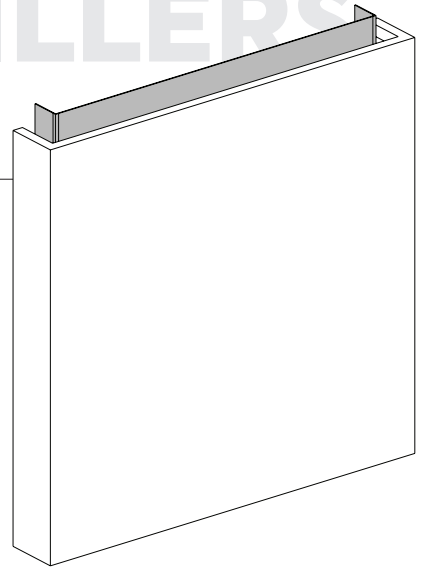

IMPORTANT

There are two options for the side finishes:

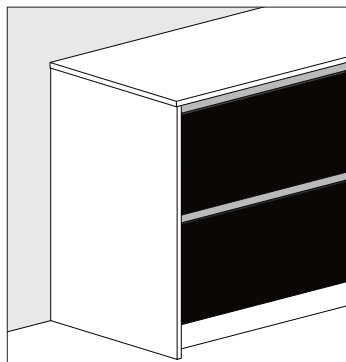

Full-height finishing panel
(FP22-2S)

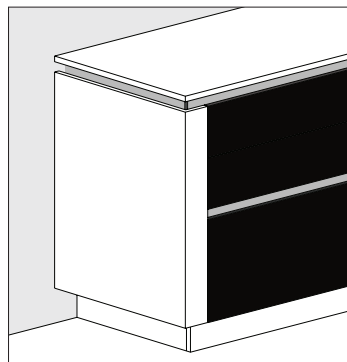

Box filler with
C-Channel (BBFL-CC)

SPECIFICATIONS

BASE CABINETS

SPECIFICATIONS

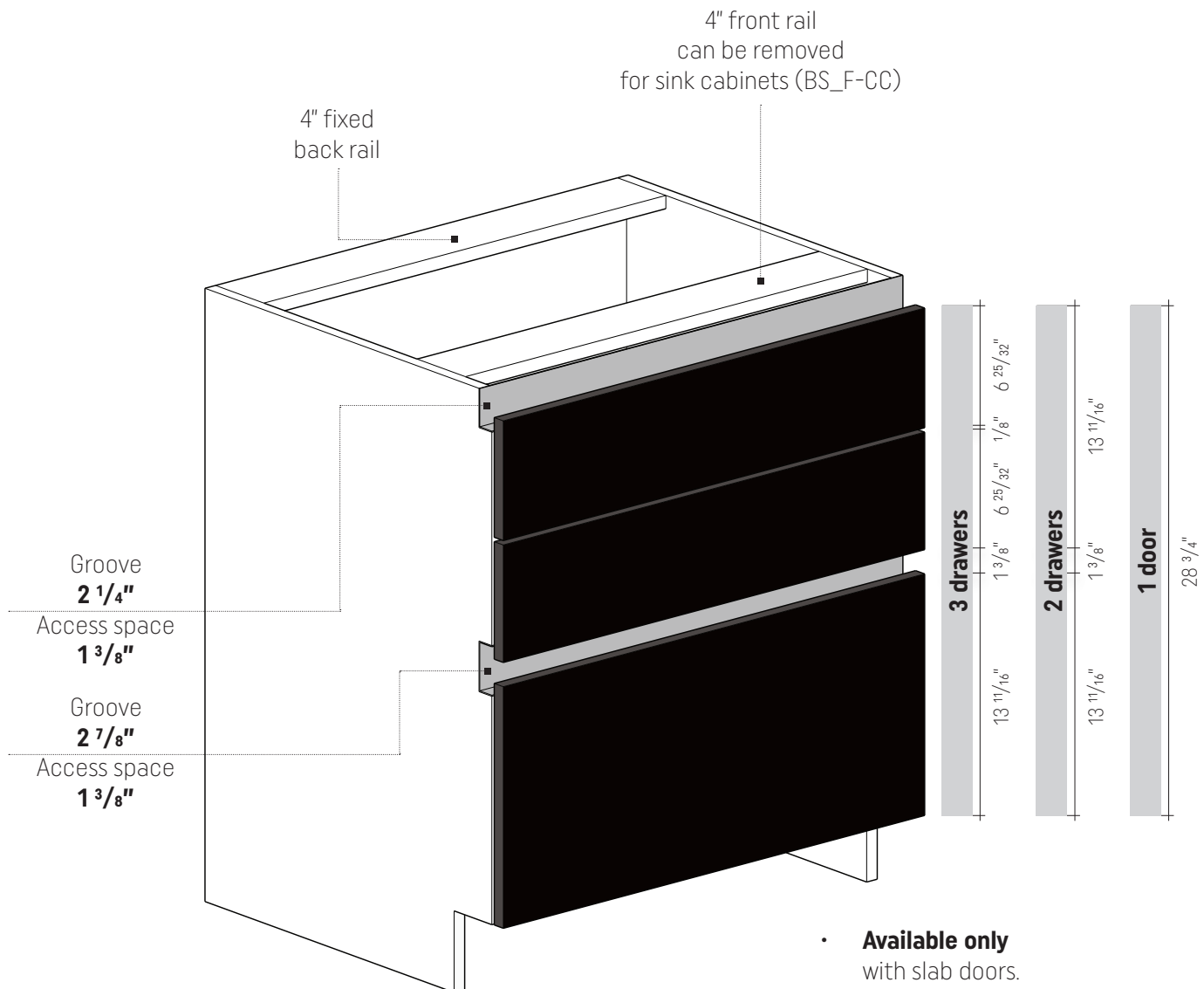

- **Available only**
with slab doors.
- Counter Type: **Not available**
for bullnose countertops

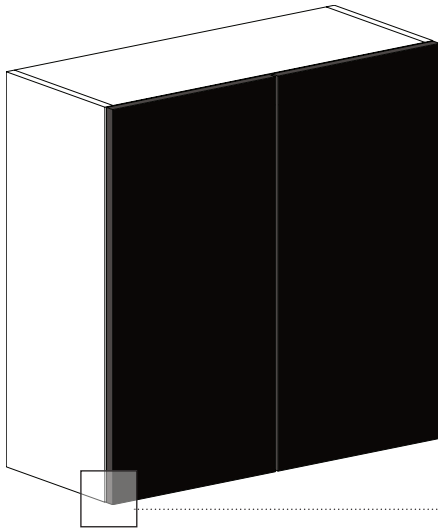

W-CC

WALL C-CHANNEL

+ \$250/cabinet

- To open the door, grip under the cabinet.

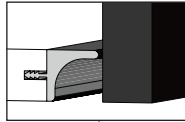

WALL CABINETS

WSS-CC

WALL STACK SECTION C-CHANNEL

+ \$250/cabinet

- To open the door, grip under the cabinet.
- The top door opens with a simple touch on the TIP-ON mechanism.
- Available with AVENTOS-HK lift up door option upon request. (*OR35 Organize Brochure*)

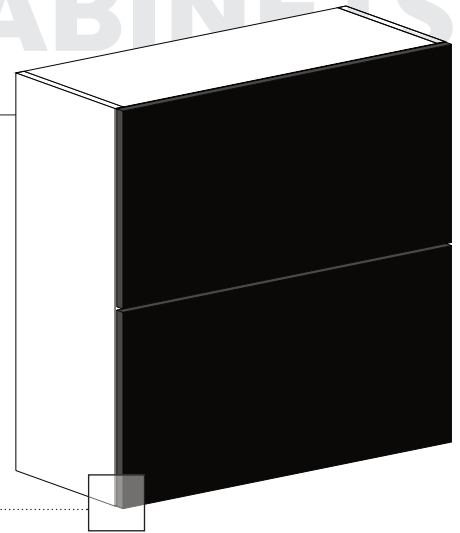
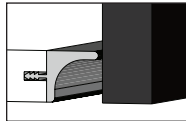

IMPORTANT

- C-Channels for wall cabinets are **installed by the manufacturer.**
- Only available in aluminum clear anodize.
- The C-Channel **is not visible** when the doors are closed.

WALL CABINETS

WOSDT-CC

WALL OPEN DOOR ON TOP C-CHANNEL

+ \$250/cabinet

- To open the door, grip under the cabinet.
- The interior of the unit comes finished.
- Microwave panel cannot be added to this unit.

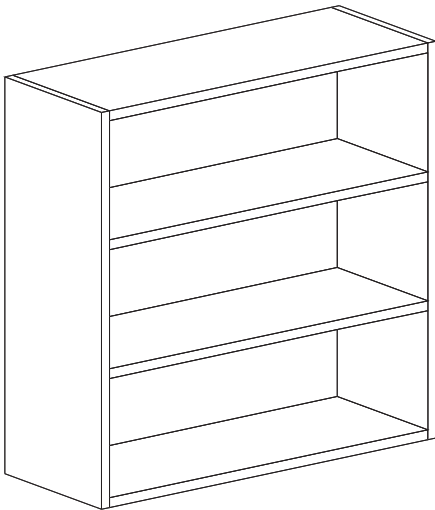
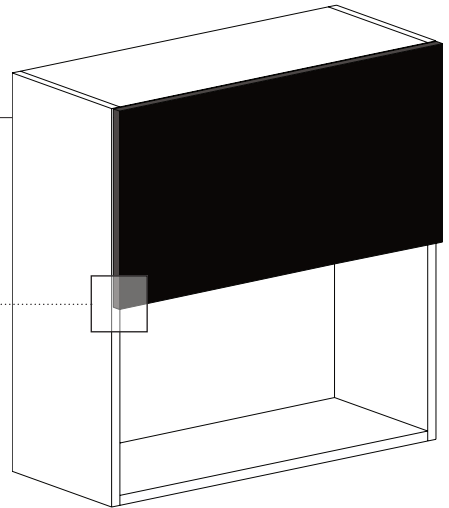
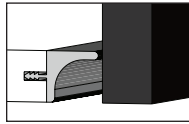

WOS

WALL OPEN SHELVES

+ \$0/cabinet

- The inside and bottom of the unit comes finished.

WC-CC

WALL CORNER C-CHANNEL

+ \$250/cabinet

- To open the door, grip under the cabinet.

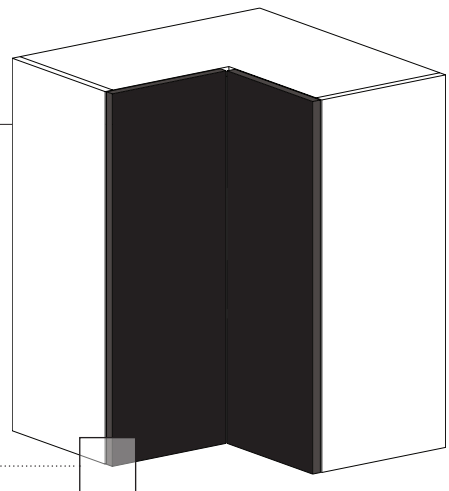
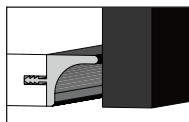

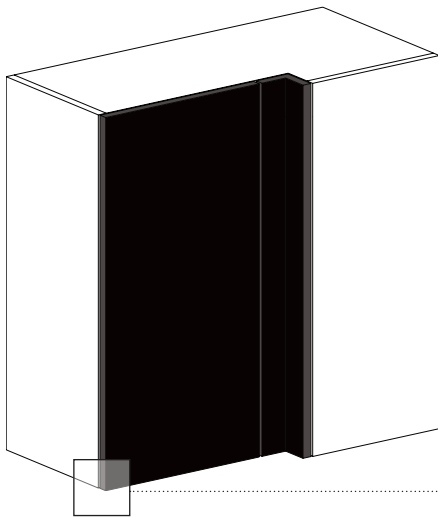

WBC-CC

WALL BLIND CORNER C-CHANNEL

+ \$250/cabinet
+ \$200/filler

- To open the door, grip under the cabinet.
- The default width of the blind corner panel is equal to the depth of the cabinet.

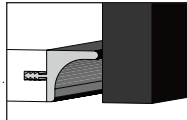

- For a perfect finish, a 3" x 3" corner filler is installed between the door and the blind corner panel.
- Unlike certain door models, it does not come with an aluminum T-Edge.

Width of the blind corner (variable)

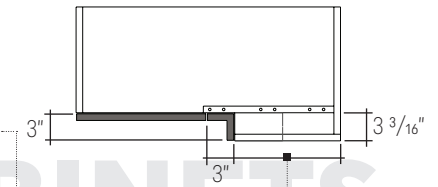

WBFU

WALL BOX FILLER TYPE U

+ \$0/cabinet

- Both sides, the front, the top and bottom come finished.
- Specify the type of filler required.

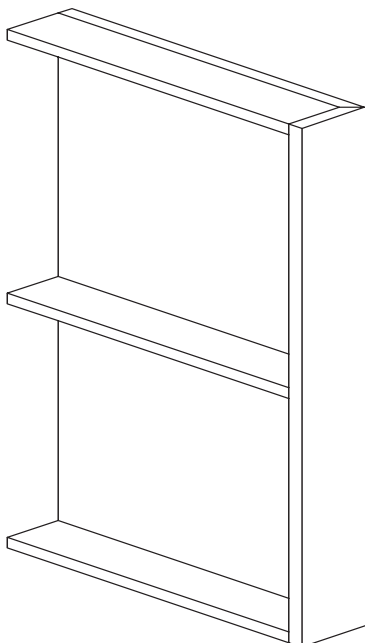
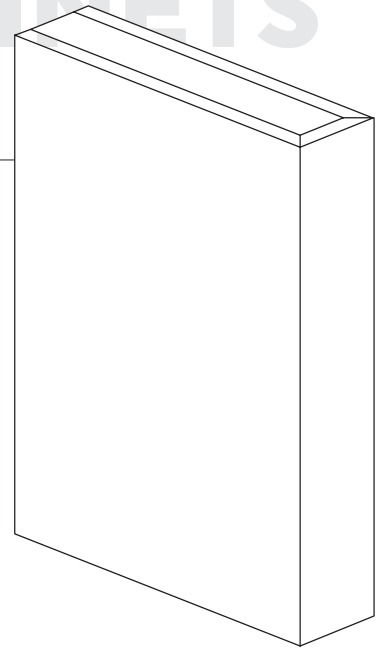

WBFL

WALL BOX FILLER TYPE L

+ \$0/cabinet

- The side, the front, the top and bottom come finished.
- Specify the type of filler required.

WALL CABINETS

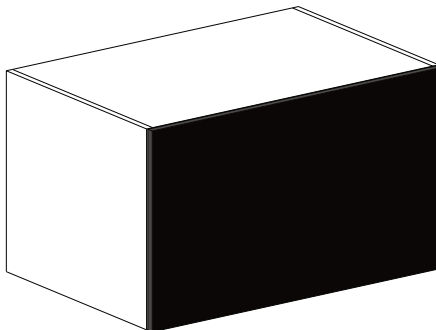

W-FR

WALL FRIDGE

+ \$50/cabinet

- Use above refrigerator.
- Fridge Wall units are only available 1-door wide.
- Indicate the side(s) with the vertical C-Channel. The cabinet door will be extended to allow the fridge door to be opened.

- See page 21 for more complete specifications.
- Presented with AVENTOS-HK. (*OR37 Organize Brochure*)

FP22-FR

FRIDGE PANNEL

+ \$0/piece

- Use when a vertical C-Channel is installed next to a refrigerator.
- A recess at the front is automatically calculated to house the vertical C-Channel.
- The price varies according to the type of cabinet construction.
- For a $\frac{5}{8}$ " construction, the panel will be $\frac{3}{4}$ " thick with no additional charges.

- Available unfinished (FP22-FR) or finished on one side (FP22-FR-1S).
- See page 21 for more complete specifications.

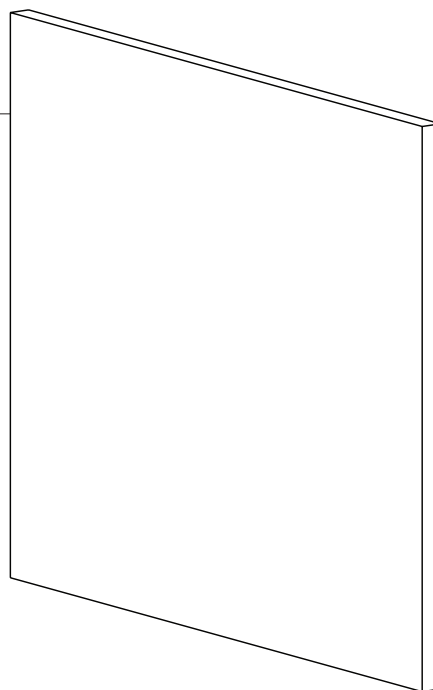

SPECIFICATIONS

REFRIGERATOR SPECIFICATIONS

- When a vertical C-Channel is installed next to a refrigerator, a full height fridge panel (FP22-FR) must be used. A recess at the front is automatically calculated for the vertical C-Channel.
- Fridge panels (FP22-FR) are always $\frac{3}{4}$ " thick.
- The width of the unit placed above the refrigerator will dictate the space remaining for the fridge.
- Use a Fridge Wall unit (W-FR) above the refrigerator.
- The Fridge Wall unit (W-FR) is only available one-door wide. The door can be opened to the left, the right or upwards, depending on the mechanism chosen.
- The door of the Wall Fridge (W-FR) will need to have a $\frac{3}{4}$ " extension. That would allow it to fit over the C-Channel.
- For a completely concealed refrigerator, the width of the door is calculated as follows:

$$\text{Door width} = \text{Width of space} - \frac{1}{8}" + (\frac{3}{4}" \times \text{number of C-Channels})$$

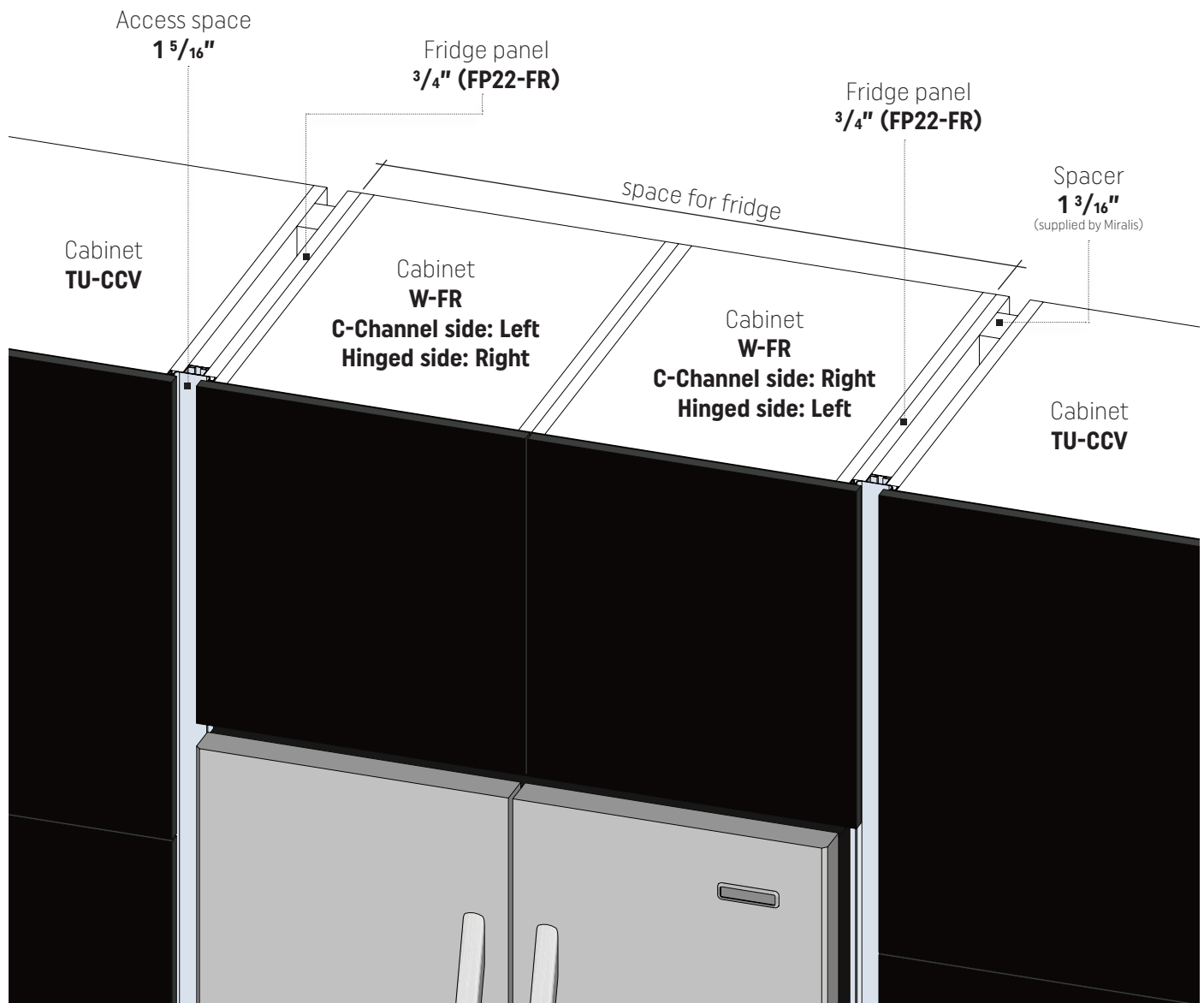

OVEN CABINETS

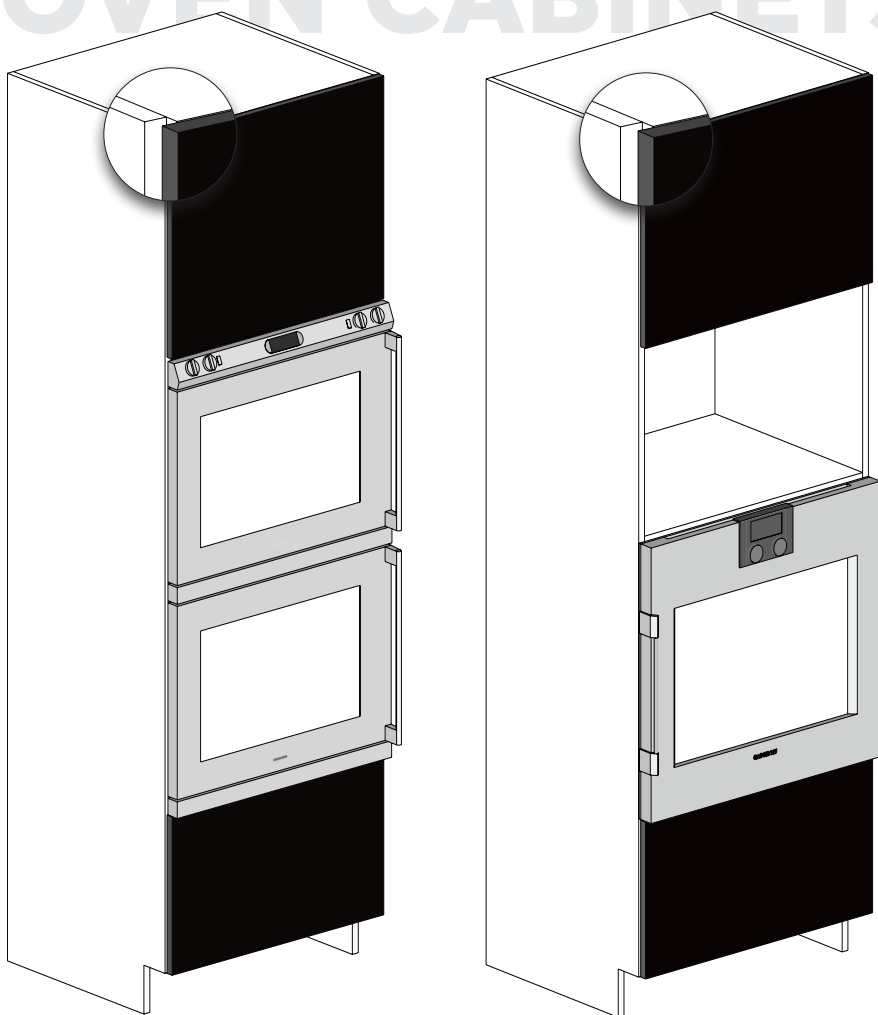

TDO1DDT-CCV

**TALL DOUBLE
OVEN 1 DRAWER
TOP DOOR
C-CHANNEL
VERTICAL**

- Please indicate the side(s) on which the vertical C-Channel will be installed.

+ \$330/cabinet

TOM1DDT-CCV

**TALL OVEN
MICROWAVE
1 DRAWER
C-CHANNEL
VERTICAL**

- Please indicate the side(s) on which the vertical C-Channel will be installed.
- The interior of the cabinet comes finished.

+ \$330/cabinet

IMPORTANT

- Sides with vertical C-Channels are **always manufactured with $\frac{3}{4}$ " thick material.**
Important if you need to calculate the interior space of an oven cabinet.
- There must be **$1\frac{3}{16}$ " allowed between units** for each vertical C-Channel.
- Vertical C-Channels are available with a **simple** or **double grip**:

DOUBLE GRIP

Used between two cabinets.

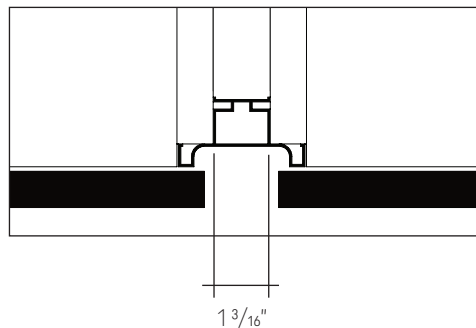

SIMPLE GRIP

Used at the ends.

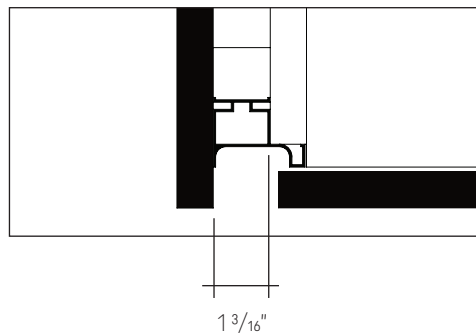

- Tall and oven cabinets are **only available in a one-door width.**

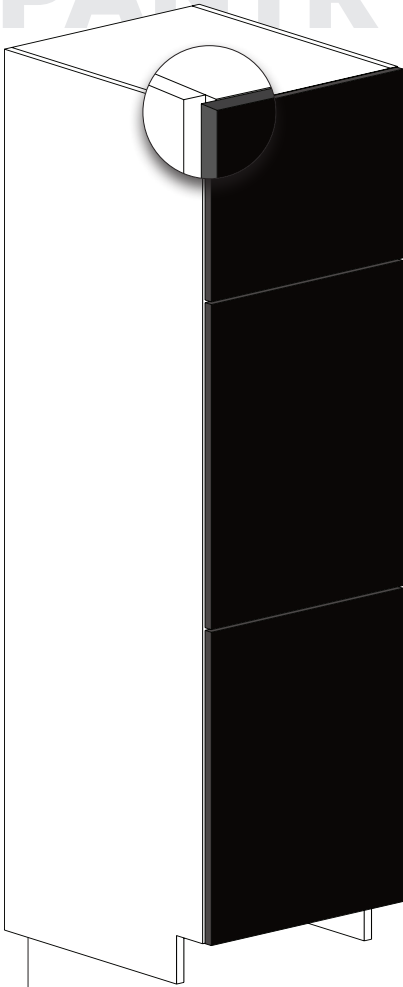

TU-CCV TALL UTILITY C-CHANNEL VERTICAL

- Please indicate the side(s) on which the vertical C-Channel will be installed.

+ \$330/cabinet

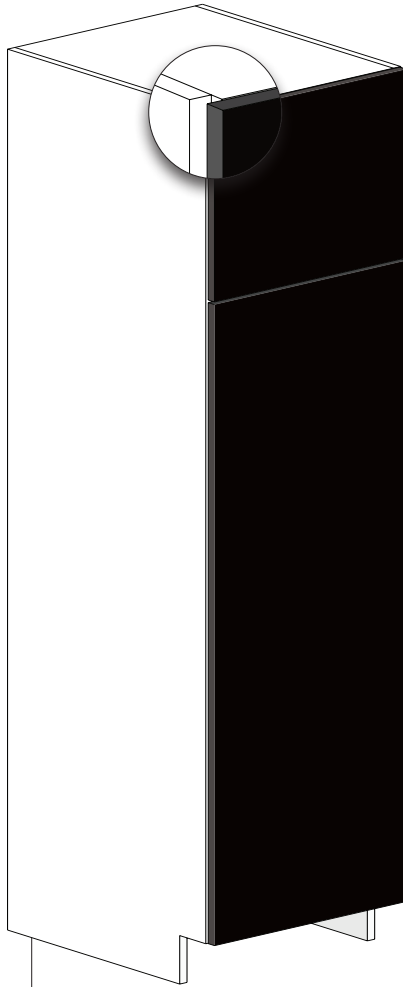

TUH-CCV TALL UTILITY TYPE H C-CHANNEL VERTICAL

- Please indicate the side(s) on which the vertical C-Channel will be installed.

+ \$330/cabinet

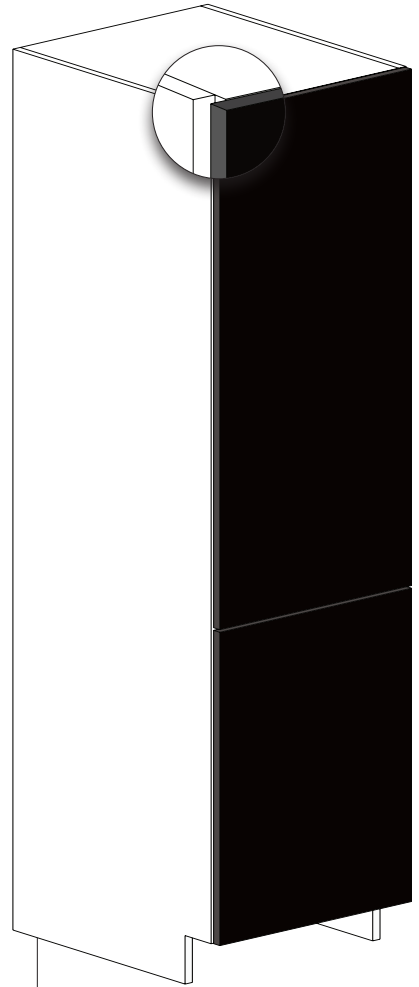

TUG-CCV TALL UTILITY TYPE G C-CHANNEL VERTICAL

- Please indicate the side(s) on which the vertical C-Channel will be installed.

+ \$330/cabinet

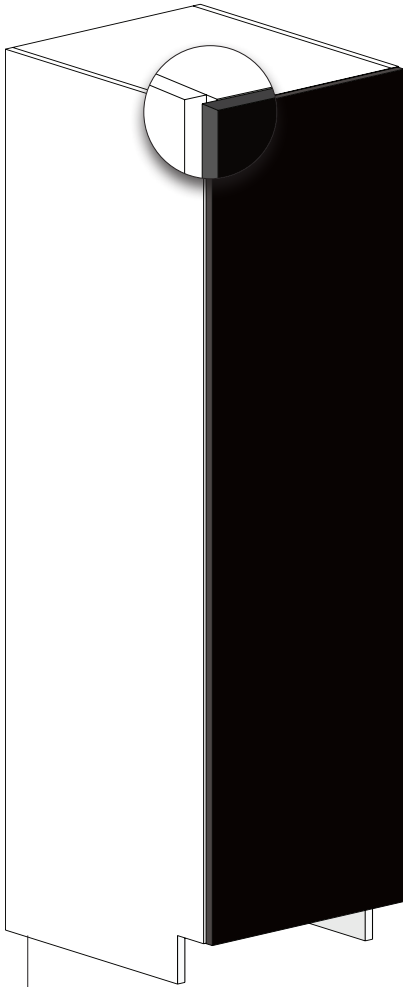

TUF-CCV

**TALL UTILITY
FULL-HEIGHT
C-CHANNEL
VERTICAL**

- Please indicate the side(s) on which the vertical C-Channel will be installed.

+ \$330/cabinet

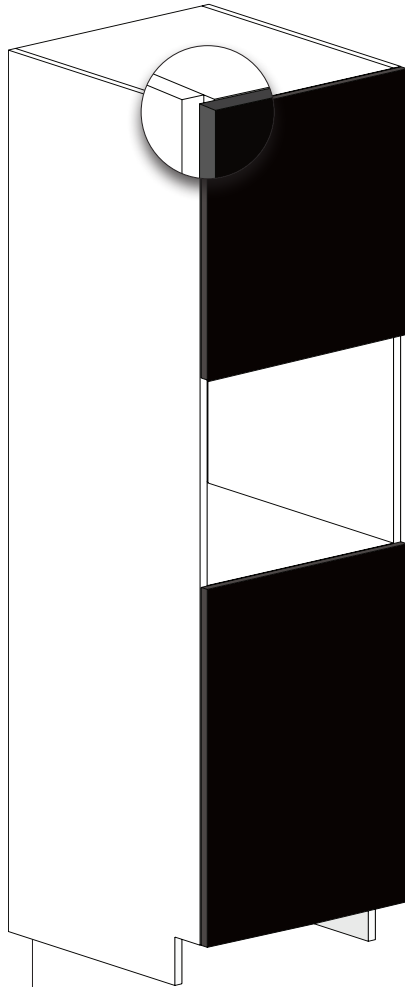

TUOSMDTB-CCV

**TALL UTILITY
MIDDLE OPEN
SHELVES TOP AND
BOTTOM DOOR
C-CHANNEL
VERTICAL**

- Please indicate the side(s) on which the vertical C-Channel will be installed.
- The interior of the cabinet comes finished.

+ \$330/cabinet

HORIZONTAL C-CHANNELS SPECIFICATIONS

- Comes in two colors : Aluminum clear anodize and Aluminum titanium anodize.
- Maximum length of horizontal channels is 4,100 mm (13' 5").
- Please note that for all requests for add-ons to an existing order, the maximum length for C-Channel molding is 9 feet due to shipping reasons.

VERTICAL C-CHANNELS SPECIFICATIONS

- Comes in two colors : Aluminum clear anodize and Aluminum titanium anodize.
- The maximum length of vertical C-Channels is 2,670 mm (8' 9").
- Please note that for all requests for add-ons to an existing order, the maximum length for C-Channel molding is 9 feet due to shipping reasons.

UPPER UNIT C-CHANNELS SPECIFICATIONS

- One color available: Aluminum clear anodize.
- The C-Channel is integrated into the bottom of the unit so the door can be opened.
- Please note that for all requests for add-ons to an existing order, the maximum length for C-Channel molding is 9 feet due to shipping reasons.

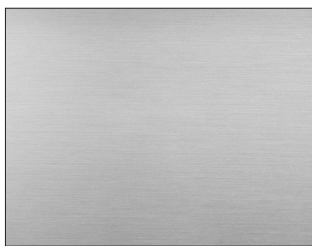

**ALUMINUM
CLEAR ANODIZE**

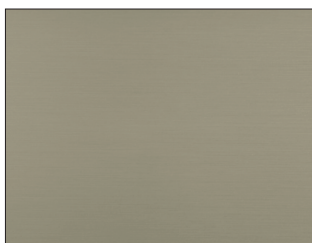

**ALUMINUM
TITANIUM ANODIZE**





© Design: Paragon Kitchens, Ontario



1501 H208 Blond Seaside

MIRALIS

200, RUE DES FABRICANTS
SAINT-ANACLET (QUÉBEC) G0K 1H0 CANADA

T 1 866 623-6686

MIRALIS.COM

