

FINGER GRIP

MIRALIS

THOSE WHO APPRECIATE PURE LINES AND MINIMALIST DESIGNS WILL DEFINITELY BE SEDUCED BY THE FINGER GRIP

A handleless, linear and minimalist kitchen concept, that's what the Finger Grip is all about.

The combination of a contemporary design with an intuitive look. The unique configuration of the door and the space between the front panels allow you to slide your fingertips for an ergonomic grip that is second to none.





SF116-M White Lace





SA350-M Northern Floe





SF119-M Black Satin

IMPORTANT

So here is the Finger Grip brochure, your perfect guide to making a dream kitchen come true in perfect harmony. Being a concept in its own right, the Finger Grip must be selected at the very beginning of the process since the cabinets and hardware are specifically adapted to it. Moreover, with its contemporary appearance, it is an obvious match for the SLAB one-piece door.

Note: With the exception of the upper cabinets, the connecting part behind the doors must be affixed to the cabinet in the specially cut grooves. Your installer will have to cut the bar then attach it to the cabinets afterwards.

BASE CABINETS

BF-FG	Base full height door	10
BS_F-FG	Base sink full height door	10
B1D-FG	Base 1 drawer	11
B2D-FG	Base 2 drawers	11
B3D-FG	Base 3 drawers	11
BC-FG	Base corner	12
BBC-FG	Base back corner	12
BBC_F-FG	Base blind corner full height door	12
BBFL-FG	Base box filler, Type L	13
BBFC-FG	Base box filler, Type C	13
	Important: base cabinets	11
	Important: side finishes	13
	Specifications: base cabinets	14

WALL CABINETS

W-CC	Wall	15
WSS-CC	Wall stack section	15
WOSDT-CC	Wall open, door on top	16
WOS	Wall open shelves	16
WC-CC	Wall corner	16
WBC-CC	Wall blind corner	17
WBFU	Wall box filler, Type U	17
WBFL	Wall box filler, Type L	17
W-FR	Wall fridge	18
	Important: wall cabinets	15
	Specifications: refrigerator	19

OVEN AND TALL CABINETS

OC1D-FGV	Tall double oven	20
OC2O1D-FGV	Tall oven microwave	20
TU-FGV	Tall utility	22
TUH-FGV	Tall utility, Type H	22
TUG-FGV	Tall utility, Type G	22
TUF-FGV	Tall utility, full-height	23
TUOSMDTB-FGV	Tall middle open shelves	23
	Important: tall and oven	21

SPECIFICATIONS

Finger Grip Moulding Specifications	24
---	----

BASE DOORS

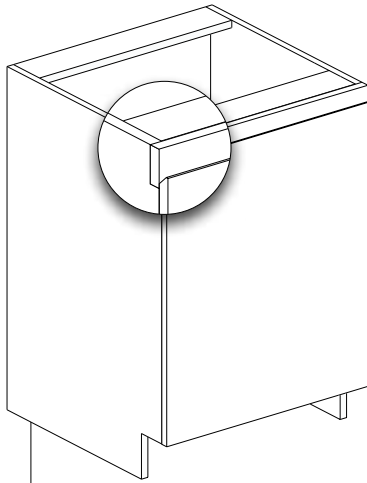

BF-FG

BASE
FULL HEIGHT DOOR
FINGER GRIP

- Available with 1 or 2 doors.

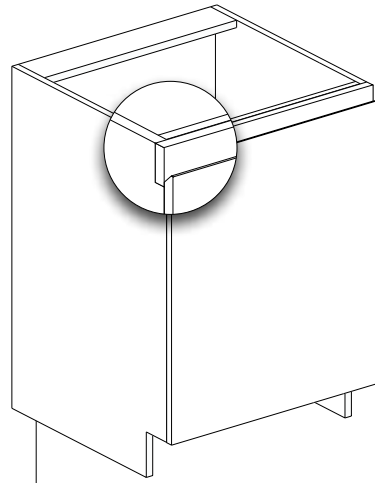

BS_F-FG

BASE SINK
FULL HEIGHT DOOR
FINGER GRIP

- The front vertical rail allows space for a large sink.

BASE DRAWERS

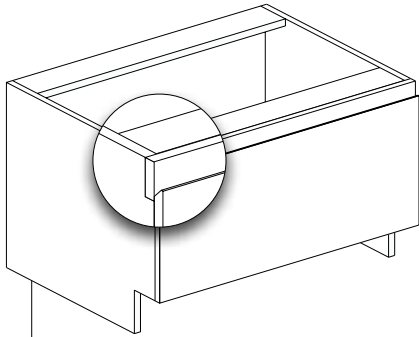

B1D-FG

BASE
1 DRAWER
FINGER GRIP

- Increase storage space by adding a roll-out shelf above the drawer.

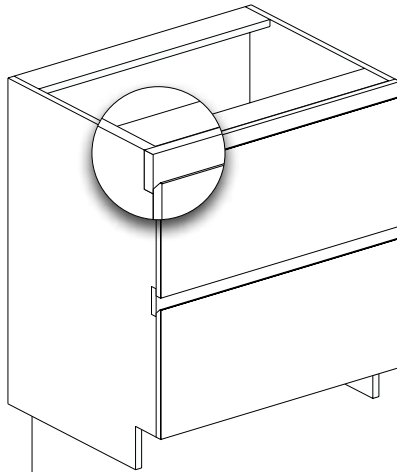

B2D-FG

BASE
2 DRAWER
FINGER GRIP

- The two drawer fronts are the same height.
- Increase storage space by adding a roll-out shelf above each drawer.

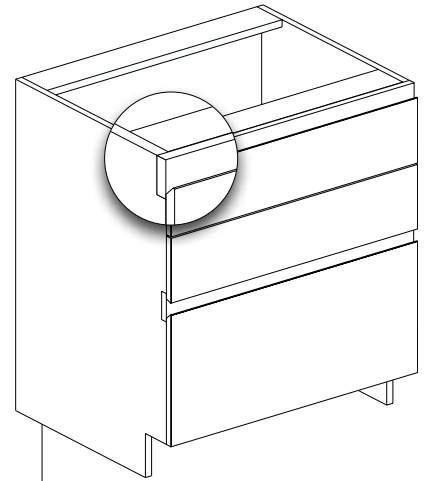

B3D-FG

BASE
3 DRAWER
FINGER GRIP

- The two upper-drawer fronts are the same height.
- The two upper-drawer fronts are the same height as the bottom-drawer front.
- Increase storage space by adding a roll-out shelf above the lower drawer.

IMPORTANT

- The Finger Grip is **placed in the upper or the middle of the unit.**
- There is **always** a Finger Grip at the top of a base cabinet.
- Access space between fronts is **1 3/8"**.
- **Concealed dishwasher?**
It must be set back 2 1/4" under the counter.

BASE CORNERS

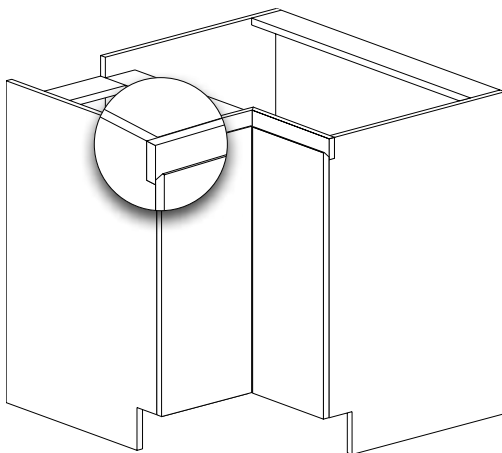

BC-FG

BASE CORNER FINGER GRIP

- A Lazy Susan can be added for easy access to the cabinet interior.
- This cabinet is shipped in two sections.

BBC-FG

BASE BACK CORNER FINGER GRIP

- A Lazy Susan can be added for easy access to the cabinet interior.

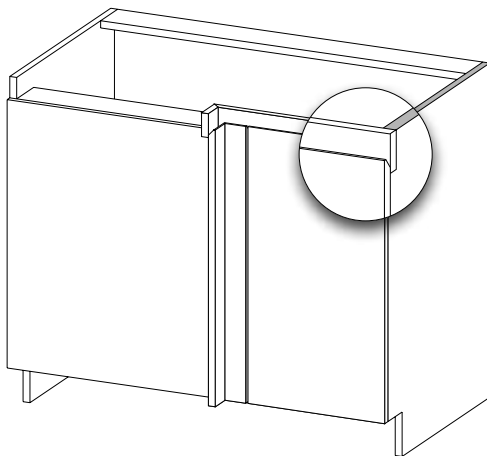
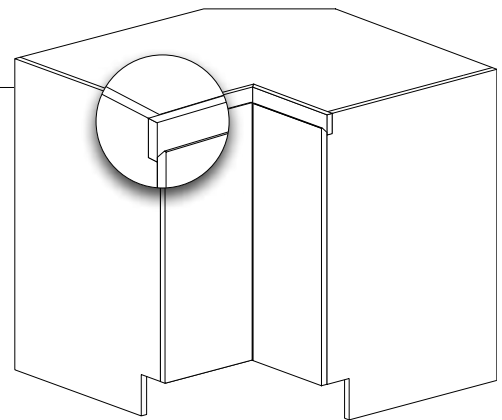

BBC_F-FG

BASE BLIND CORNER FINGER GRIP

- The default width of the blind corner panel is equal to the depth of the cabinet.
- For a perfect finish, a 3" x 3" corner filler is installed between the door and the blind corner panel.

- The blind corner comes unfinished.

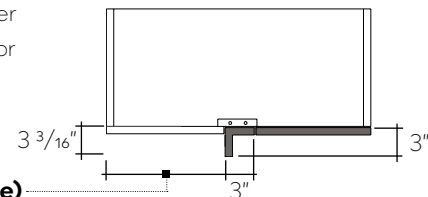

Width of the blind corner (variable)

BOX FILLERS

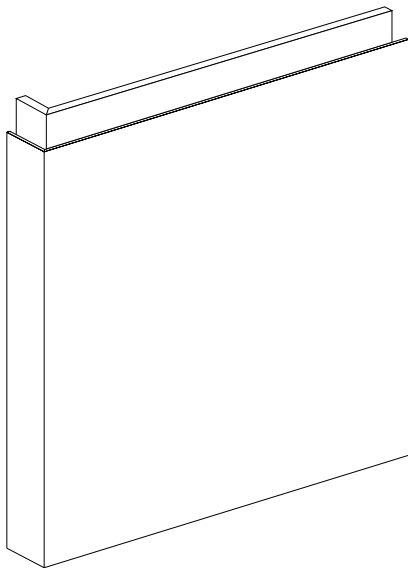

BBFL-FG

BASE BOX FILLER TYPE L FINGER GRIP

- Designed for the Finger Grip to continue around the cabinet side.
- All box fillers are 3" thick.
- The box filler is made of the same material as the doors.

BBFC-FG

BASE BOX FILLER TYPE C FINGER GRIP

- Designed for the Finger Grip to continue around the cabinet side and back.
- All box fillers are 3" thick.
- The box filler is made of the same material as the doors you order.

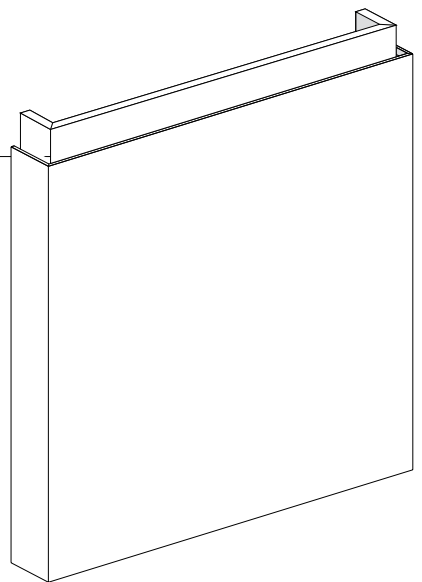

IMPORTANT

There are two options for the side finishes:

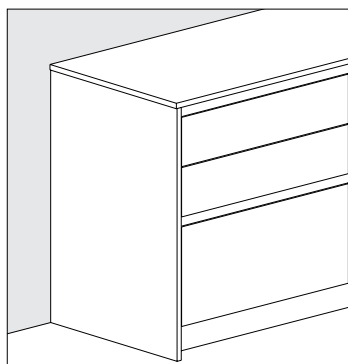

Full-height finishing panels
(FP-2S)

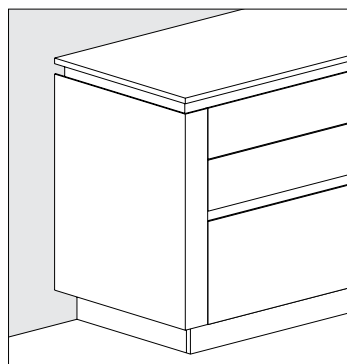

Box filler with Finger Grip
(BBFL-FG)

SPECIFICATIONS

BASE CABINETS SPECIFICATIONS

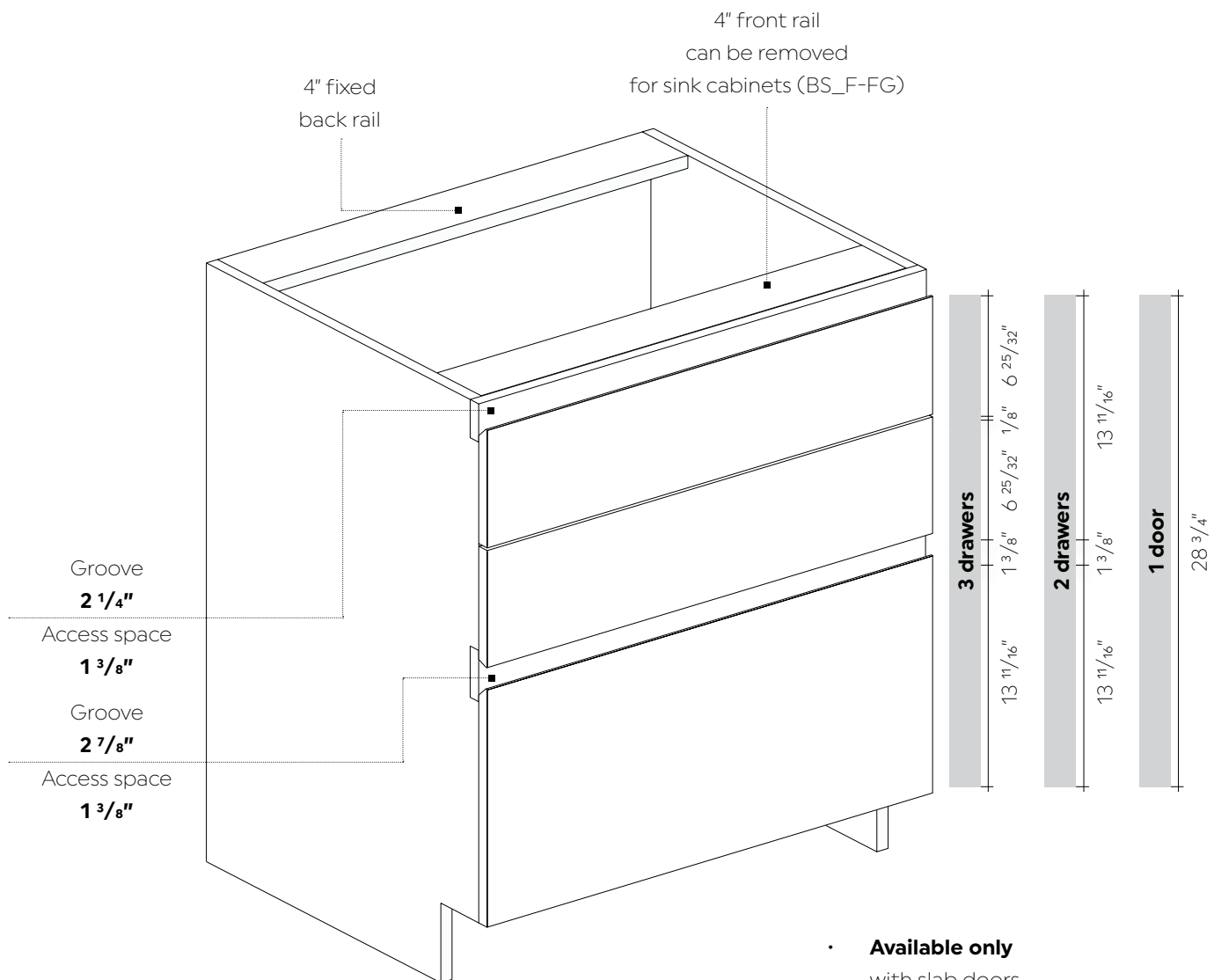

- **Available only** with slab doors.
- Counter Type: **Not available** for bullnose countertops

WALL CABINETS

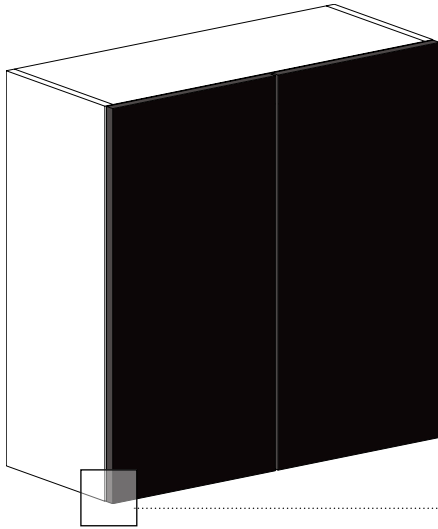

W-CC

WALL C-CHANNEL

- To open the door, grip under the cabinet.

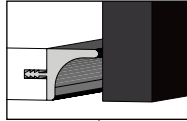

WSS-CC

WALL STACK SECTION C-CHANNEL

- To open the door, grip under the cabinet.
- The top door opens with a simple touch on the TIP-ON mechanism.
- Available with AVENTOS-HK lift up door option upon request.

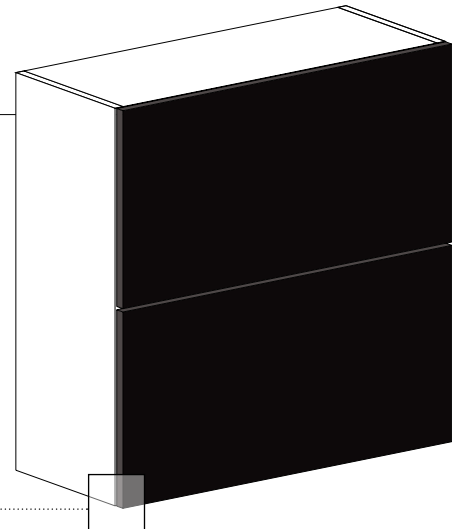
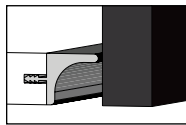

IMPORTANT

- C-Channels for wall cabinets are **installed by the manufacturer.**
- Only available in aluminum clear anodize.
- The C-Channel **is not visible** when the doors are closed.

WALL CABINETS

WOSDT-CC

WALL OPEN DOOR ON TOP C-CHANNEL

- To open the door, grip under the cabinet.
- The interior of the unit comes finished.
- Microwave panel cannot be added to this unit.

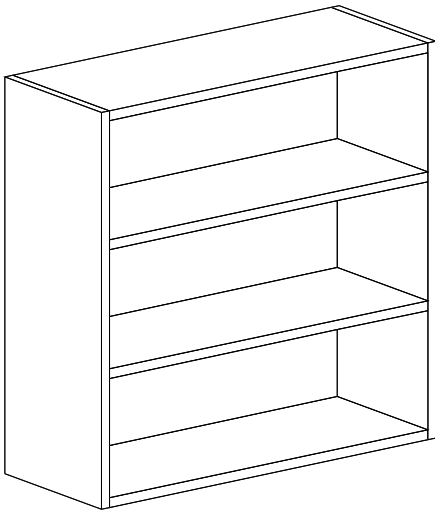
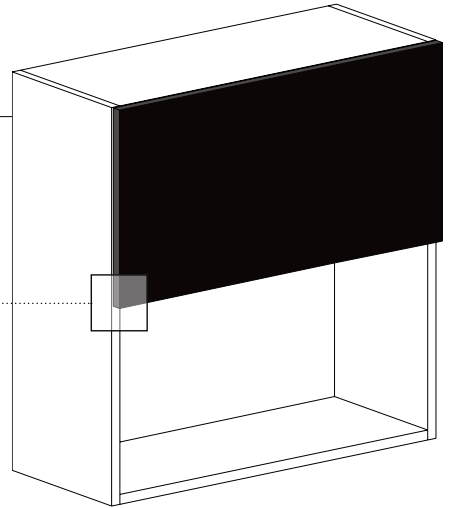
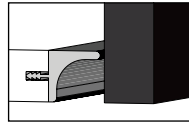

WOS

WALL OPEN SHELVES

- The inside and bottom of the unit come finished.

WC-CC

WALL CORNER C-CHANNEL

- To open the door, grip under the cabinet.

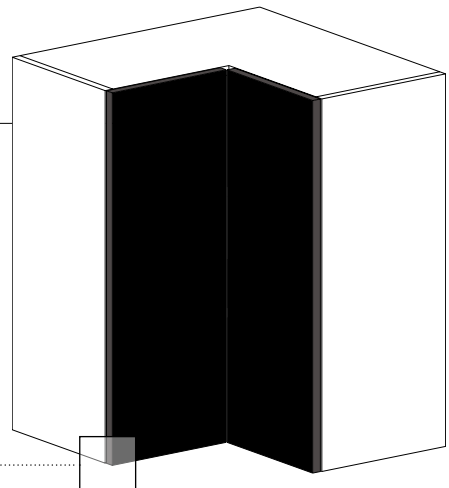
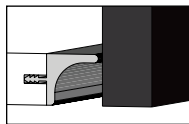

WALL CABINETS

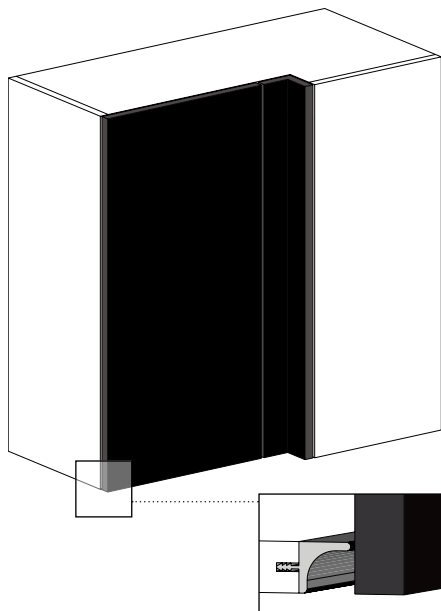

WBC-CC

WALL BLIND CORNER C-CHANNEL

- To open the door, grip under the cabinet.
- The default width of the blind corner panel is equal to the depth of the cabinet.
- For a perfect finish, a 3" x 3" corner filler is installed between the door and the blind corner panel.

- Unlike certain door models, it does not come with an aluminum T-Edge.

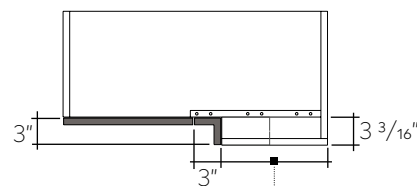

Width of the blind corner (variable)

WBFU

WALL BOX FILLER TYPE U

- Both sides, the front, the top and bottom come finished.
- Specify the type of filler required.

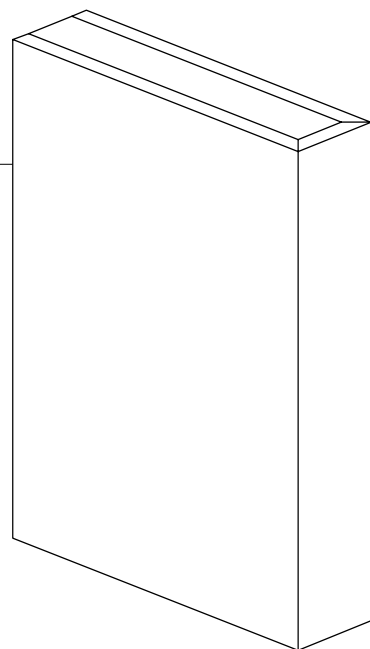
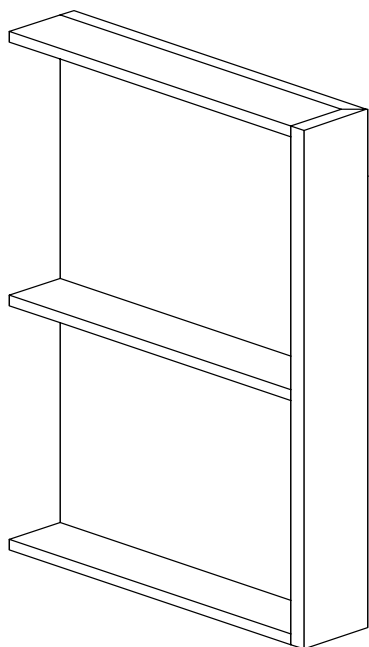

WBFL

WALL BOX FILLER TYPE L

- The side, the front, the top and bottom come finished.

WALL CABINETS

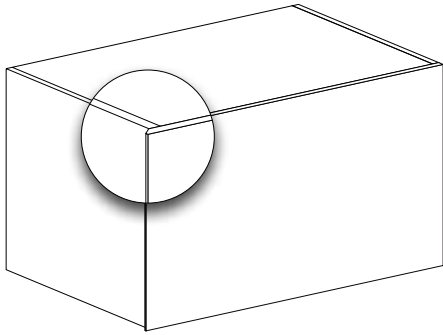

W-FR

WALL FRIDGE

- Use above refrigerator.
- Fridge Wall units are only available 1-door wide.
- Indicate the side(s) with the vertical Finger Grip. The cabinet door will be extended to allow the fridge door to be opened.
- See page 21 for more complete specifications.

SPECIFICATIONS

REFRIGERATOR SPECIFICATIONS

- When a vertical Finger Grip notch is on the side of a refrigerator, a full-height panel (FP-1S) must be installed. Allow for a front setback of 3/4" for the vertical Finger Grip notch.
- The width of the unit placed above the refrigerator will dictate the space remaining for the fridge.
- Use a Fridge Wall unit (W-FR) above the refrigerator.
- The Fridge Wall unit (W-FR) is only available one-door wide. The door can open to the left, the right or upwards, depending on the mechanism chosen.
- The door of the Wall Fridge (W-FR) will need to have a 3/4" extension, which would allow it to fit over the Finger Grip.
- For a completely concealed refrigerator, the width of the door is calculated as follows:

$$\text{Door width} = \text{Width of space} - \frac{1}{8}" + (\frac{3}{4}" \times \text{number of vertical Finger Grip})$$

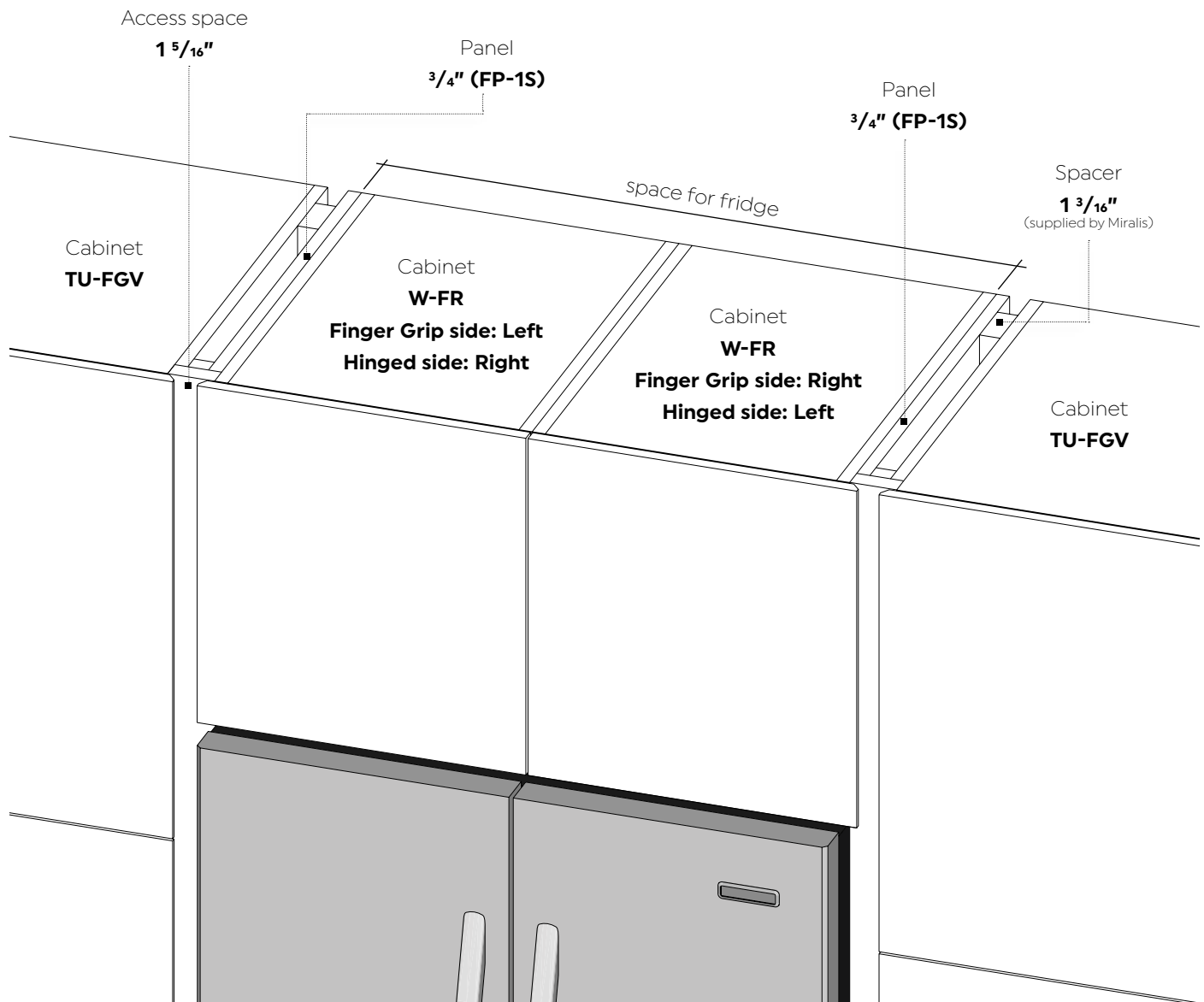

OVEN CABINETS

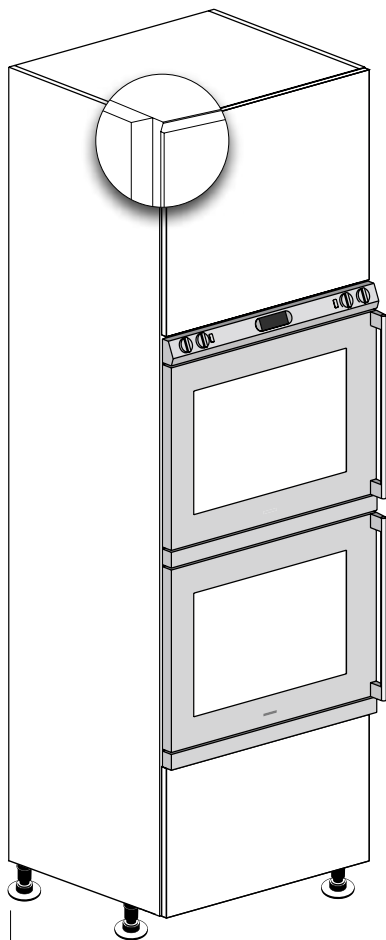

OC1D-FGV **OVEN CABINET** **1 DRAWER**

- Please indicate the side(s) on which the vertical Finger Grip will be installed.
- Opening unfinished by default.

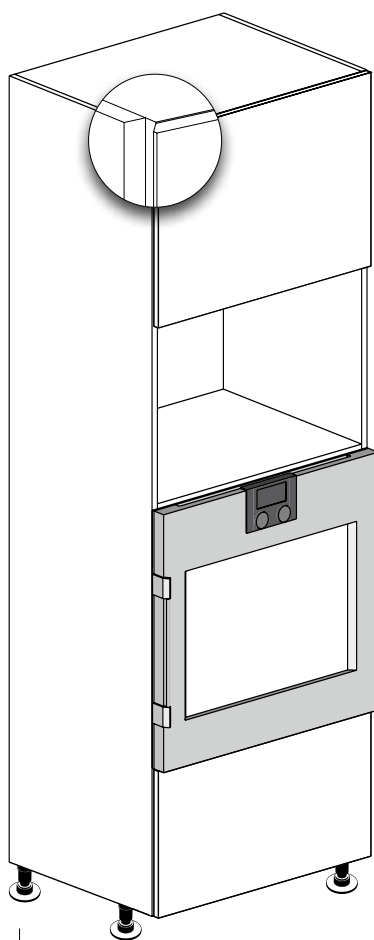

OC2O1D-FGV **OVEN CABINET** **2 OVENS** **1 DRAWER**

- Please indicate the side(s) on which the vertical Finger Grip will be installed.
- Opening unfinished by default.

IMPORTANT

- Sides with vertical Finger Grip are **always manufactured with $\frac{3}{4}$ " thick material.**
Important if you need to calculate the interior space of an oven cabinet.
- There must be **$1\frac{3}{16}$ " allowed between units** for each vertical Finger Grip.
- Vertical Finger Grip is available with a **single** or **double grip**:

DOUBLE GRIP

Used between two cabinets.

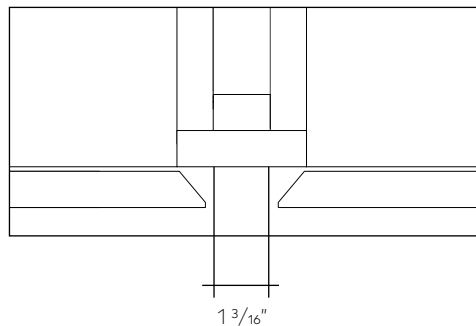

SINGLE GRIP

Used at the ends.

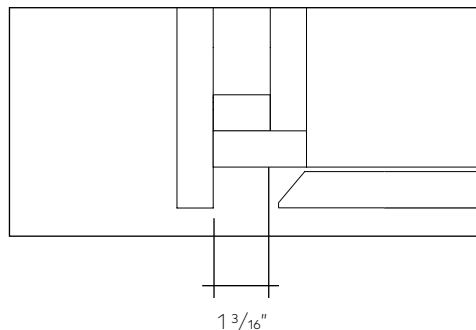

- Tall and oven cabinets are **only available in a one-door width.**

PANTRY

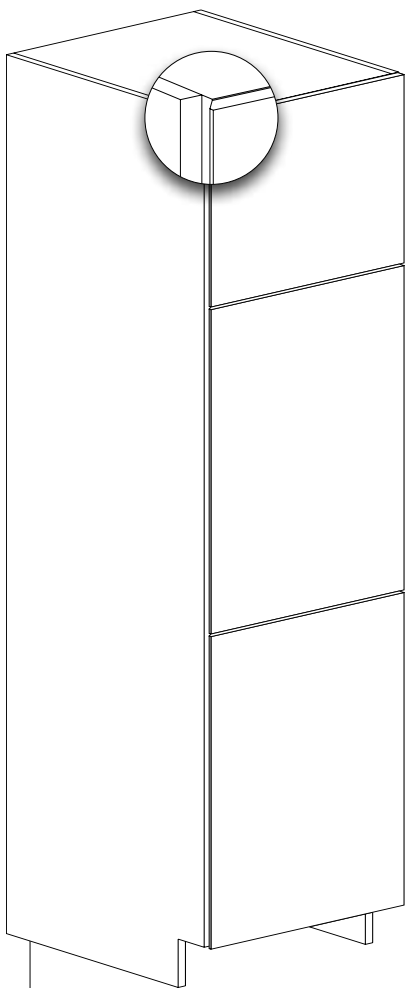

TU-FGV **TALL UTILITY** **FINGER GRIP** **VERTICAL**

- Please indicate the side(s) on which the vertical Finger Grip will be installed.

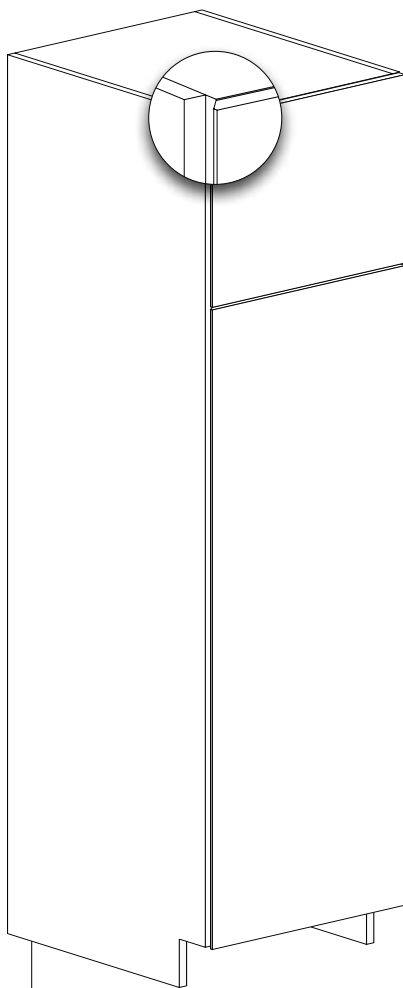

TUH-FGV **TALL UTILITY** **TYPE H** **FINGER GRIP** **VERTICAL**

- Please indicate the side(s) on which the vertical Finger Grip will be installed.

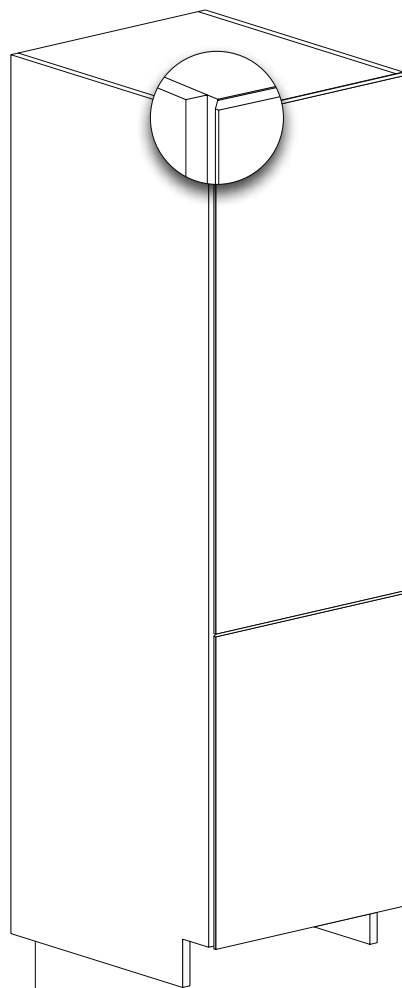

TUG-FGV **TALL UTILITY** **TYPE G** **FINGER GRIP** **VERTICAL**

- Please indicate the side(s) on which the vertical Finger Grip will be installed.

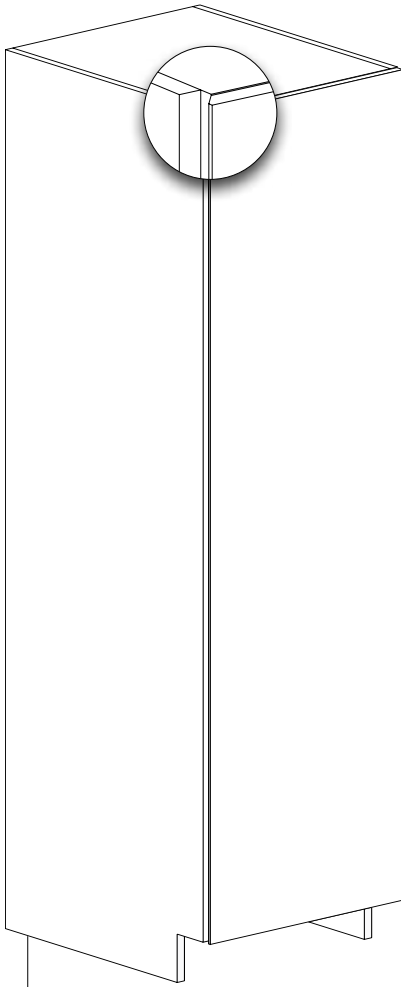

TUF-FGV

**TALL UTILITY
FULL-HEIGHT
FINGER GRIP
VERTICAL**

- Please indicate the side(s) on which the vertical Finger Grip will be installed.

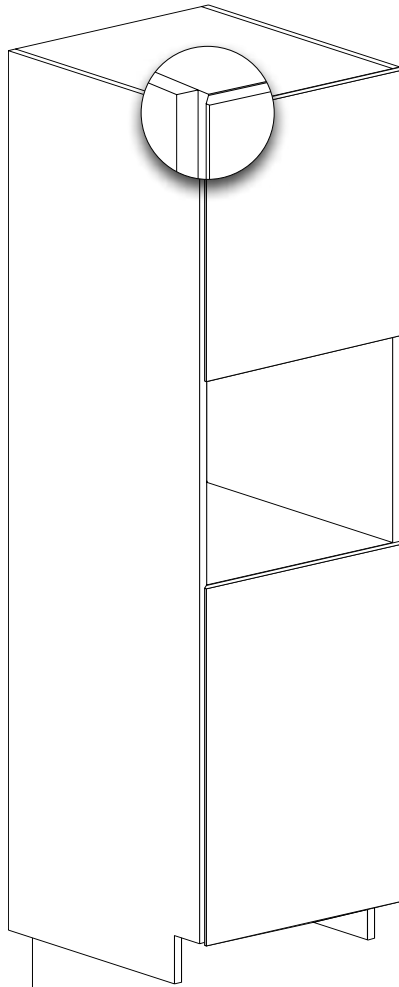

TUOSMDTB-FGV

**TALL UTILITY
MIDDLE OPEN
SHELVES TOP AND
BOTTOM DOOR
FINGER GRIP
VERTICAL**

- Please indicate the side(s) on which the vertical Finger Grip will be installed.
- The interior of the cabinet comes finished.

FINGER GRIP MOULDING SPECIFICATIONS

- Available on all Miralis materials, without exception.
- The length of the molding depends on the selected material.





Walnut, Fc

MIRALIS

200, RUE DES FABRICANTS
SAINT-ANACLET (QUÉBEC) G0K 1H0 CANADA

T 1 866 623-6686

MIRALIS.COM

